

INNOVATIVE ENERGY, INC.

Reflective Insulation • Radiant Barriers • Insulated Packaging

R-VALUE <sup>up to</sup> **6.0**

DO-IT-YOURSELF



## Garage Door

insulation kit

**HELPS REDUCE RADIANT HEAT BUILDUP IN YOUR GARAGE!**

- Improves thermal performance
- Easily installs in 60 minutes or less
- All-in-one kit includes everything you need:
  - (4) 24" x 18" rolls of reflective insulation
  - (1) 1 1/2" x 60 yard roll of double-sided tape
  - (1) Disposable knife
  - (1) Tape measure
- Rolls accommodate up to an 18' x 8' door or can easily be cut down to fit smaller door sizes



[www.insul.net](http://www.insul.net)

800-776-3645



# Garage Door

insulation kit

## Installation Instructions

**READ ALL INSTRUCTIONS  
BEFORE STARTING!**

**HELPS REDUCE RADIANT HEAT BUILDUP IN YOUR GARAGE!**

### Innovative Energy Limited Warranty

Innovative Energy products are warranted against defects in materials and workmanship for 5 years, in approved building or O.E.M. applications when installed in accordance with Innovative Energy's written instructions.

Liability under this warranty is limited to replacement of the product found to be defective and does not cover merchantability, fitness for specific application or any labor costs. Contact Innovative Energy for proper handling of any suspected defective material.

For details on General Terms and Conditions of this warranty and warranty information for applications other than mentioned above, contact Innovative Energy.

### WARRANTY DISCLAIMERS AND LIMITATIONS ON BUILDING APPLICATIONS

- Innovative Energy products should always be stored in a clean dry environment with the rolls left in the poly bags they came in.
- Although Innovative Energy products have UV and thermal blockers built in to the structures, the warranty does not cover installation in open or exposed applications such as lean-to's and open sided animal confinement buildings.
- Applications where chemicals and off gassing products are present may void the warranty.

Connect with us on:



Proudly made in the USA



## DIRECTIONS

**STEP 1.** Using alcohol wipes supplied, clean garage door panel framework where reflective insulation is to be applied. Peel one side of double-sided tape and press firmly and evenly to garage door panel framework (best applied at 65°F - 100°F).

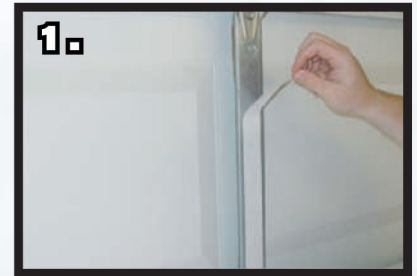

**STEP 2.** Measure and cut each roll of insulation to fit over the mounted strips of double-sided tape. Test fit each piece to ensure proper sizing for each panel.



**STEP 3.** Remove the release liner from the tape and firmly press the reflective insulation against the adhesive, working from side to side or top to bottom. Trim any excess insulation.



**Note:**  
Please wear proper safety equipment



Printed on Recycled Paper



Forest Stewardship Council  
The Mark of Responsible Forestry

**INNOVATIVE ENERGY, INC.**

*Reflective Insulation • Radiant Barriers • Insulated Packaging*

www.insul.net **800-776-3645**